

# THE STOCK ROOM

(Maximum Seating Capacity 24 Persons)

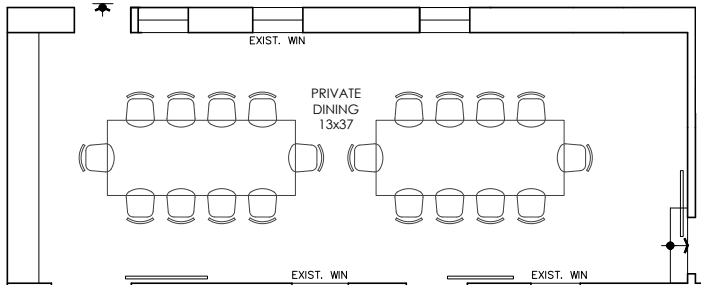

## Seating Option A

Accommodates 20 Seated Guests

2 9' Long Custom Wood Tables\* (20 Guests)

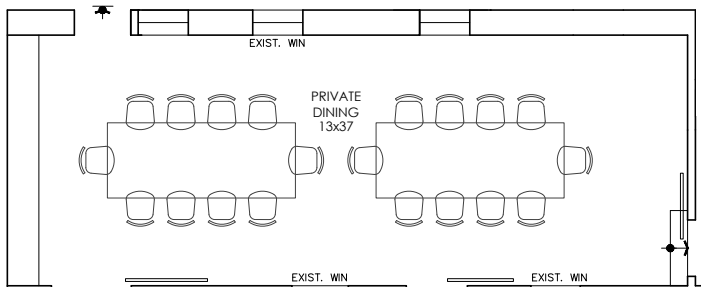

## Seating Option B\*\*

2 Tables Used For: Additional Seating (20 Guests),  
a Buffet or Station Offerings

*\*Cannot be removed or moved*

*\*\*Room Used in Conjunction to Our Larger Event Room*



(See Full Layout Schematic on Reverse Side)

